

Access guide in **DELSOL**

Access to Virtual Labs

In order for you to connect to the “DELSOL” application, you will initially have to access the Virtual Labs web portal of the Universidad Europea.

The link for this is the following:
<https://virtuallabs.universidadeuropea.es/en>

 Guía de acceso

Selecciona tu acceso:



 Software incluido



 Software incluido



 Software incluido



 Software incluido



 Software incluido



 Software incluido

Access to Non-Graphic Cycles

Next, you will need to access the virtual machine called “Non-Graphic Cycles”, in which the “DELSOL” application is installed.

Guía de acceso

Selecciona tu acceso:



Software incluido



Software incluido



Software incluido



Software incluido



Entering credentials

Afterwards, the access portal to your personal account will appear.

When you get to this point, you will need to enter the credentials that the Universidad Europea provided you.

Typically, most accounts will look like this:

- XXXXfaculty (teachers)
- XXXXXXXXfaculty (students)



Bienvenido a la Universidad Europea. Aquí encontrarás todo lo que necesitas para disfrutar de tu experiencia universitaria.

Iniciar sesión

[Iniciar sesión mediante un certificado X.509](#)

Si tienes algún problema para acceder, utiliza la plataforma de modificación y recuperación de la contraseña

<https://password.europaeducationgroup.com/>
Recupera el acceso a tu cuenta, si has olvidado tu contraseña.

Si eres alumni, te invitamos a que visites nuestra web:
<https://alumni.universidadeuropea.com/>

Selection of Cic_NG_01

When this window appears, you will have to select the virtual machine “ADFS-Cic_NG_01”, that is, the one that corresponds to “Non-Graphic Cycles”.

This step will confirm that you want to access that machine.

If it does not appear, you will have to contact your manager, so that they can solve your incident in the shortest possible time.

Seleccione una función:

▼ Account:

ADFS-Cic_G_01

ADFS-Cic_NG_01

Español ▼

[Términos de uso](#) [Política de privacidad](#) © 1996-2021, Amazon Web Services, Inc. o sus empresas afiliadas.

Access to DELSOL

Once inside, all the applications that the “Non-Graphic Cycles” virtual machine has will appear.

To access “DELSOL”, all you have to do is click on the icon that is displayed.



Choose your app to get started



arduino



audacity



Brackets



DELSOL



Desktop



Docker



eclipse



notepad++



OBS Studio 64



Packet Tracer 7



PostgreSQL
pgAdmin4



POWERPOINT



PUBLISHER



python



Unity 2020



Visual Studio 2019



WORD



xampp-control



xMicoPyEditor



xNormal

Loading process

In the next step, you will need to wait a few moments for the application settings to load.

The waiting time may vary depending on your Internet connection.



Your session is being prepared. The session should be available in less than 01:48

Cloud access key

After waiting, "DELSOL" will start automatically, and a new window will open.

Here, the application will ask you for the "cloud access key", which is configured as "*Delsol@5*".

This password will be requested every time you start "DELSOL", since there is no option to "remember password".

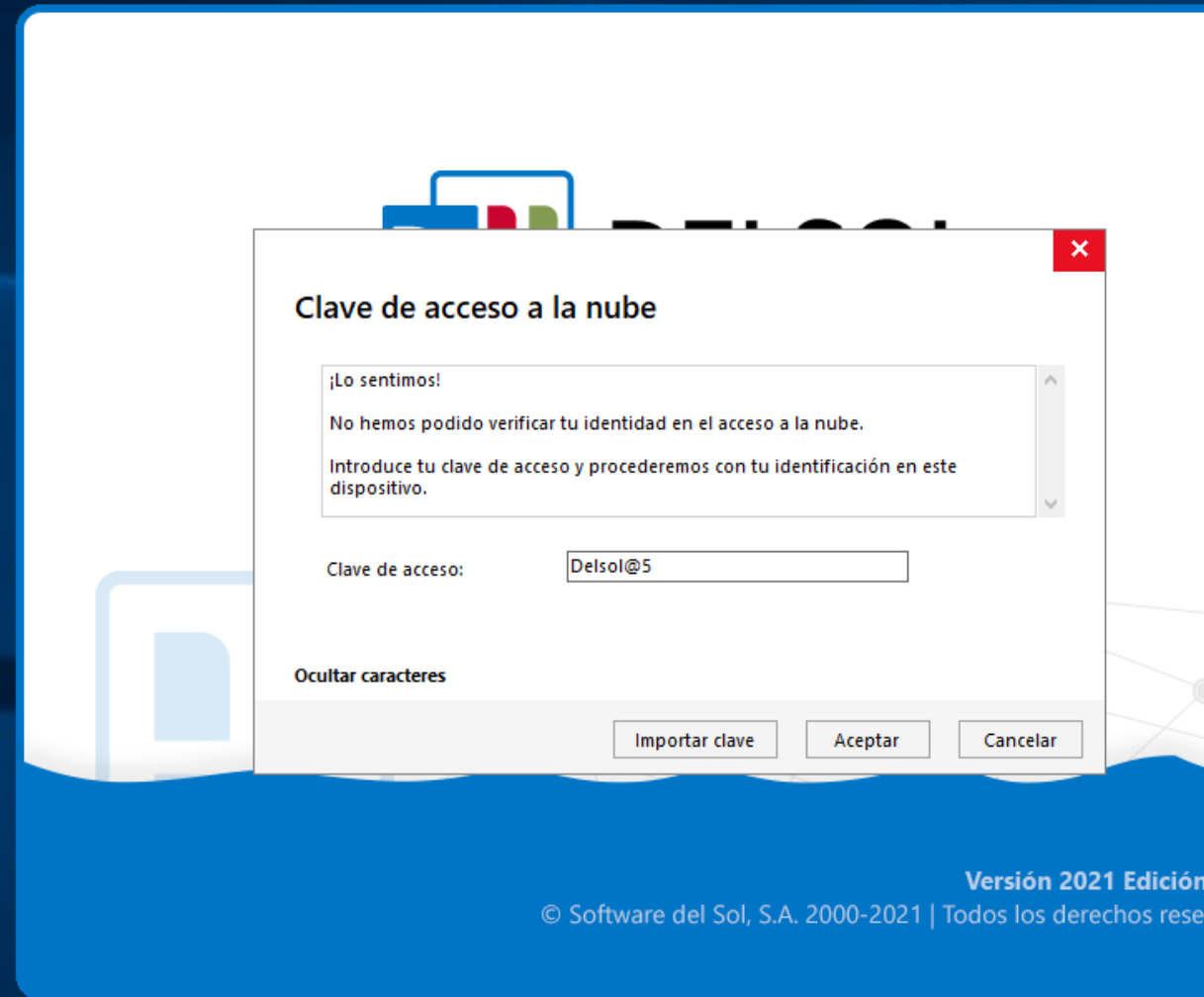

Confirmation window

When you have entered the password, you will notice that “DELSOL” will display an endless loading screen, and will not finish starting.

This problem occurs because the application does not automatically launch the window to confirm the "cloud access key".

Therefore, you have to open it manually.

In the image you can see where this window is located. Specifically, it is located on the task bar, on the icon corresponding to "DELSOL".

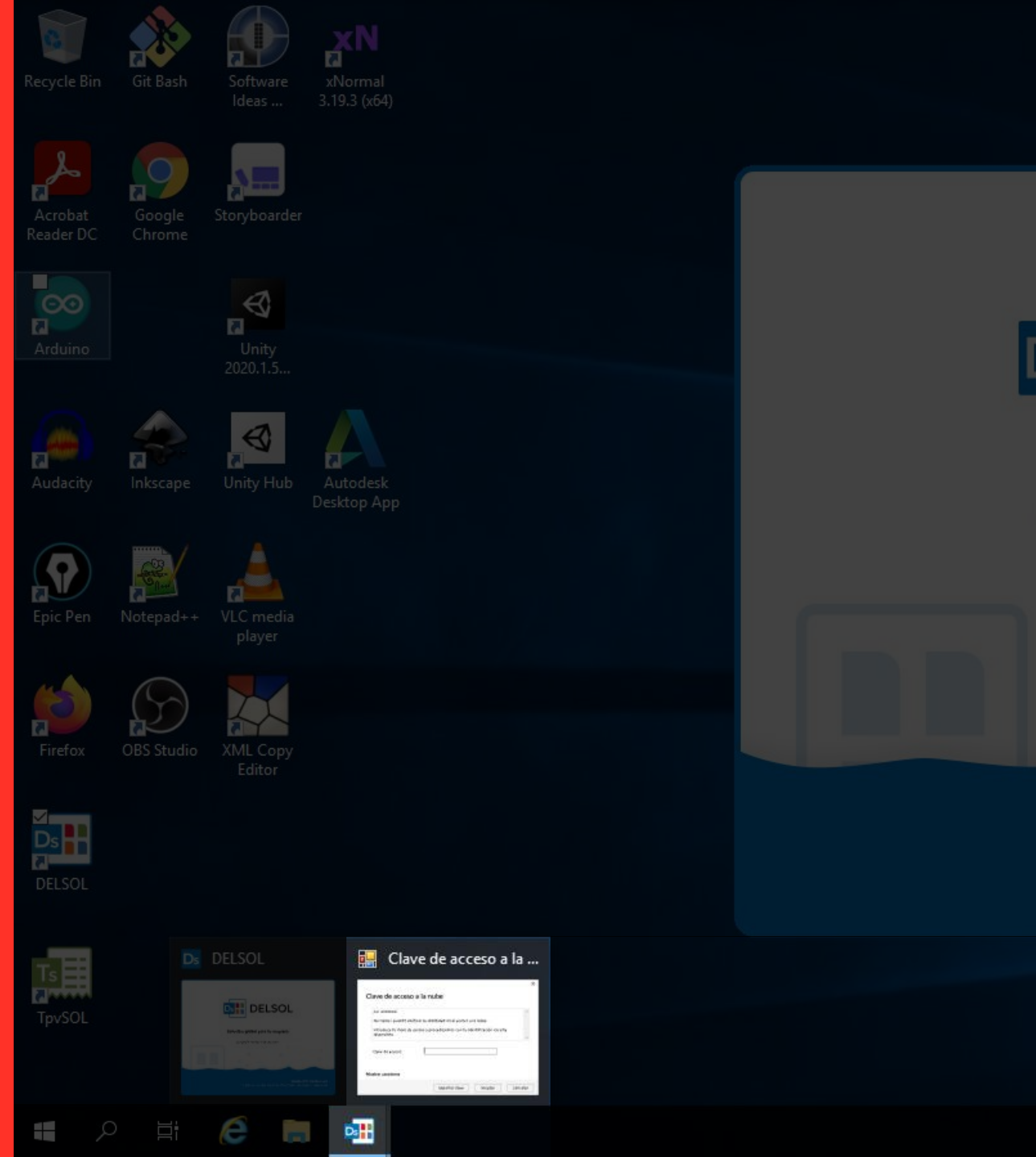

Confirmation code

You will then see the same login interface that you saw earlier.

Here, you will have to put the same password again, that is:
"Delsol@5".

In short, you will always have to enter the same password twice,
as a security method.

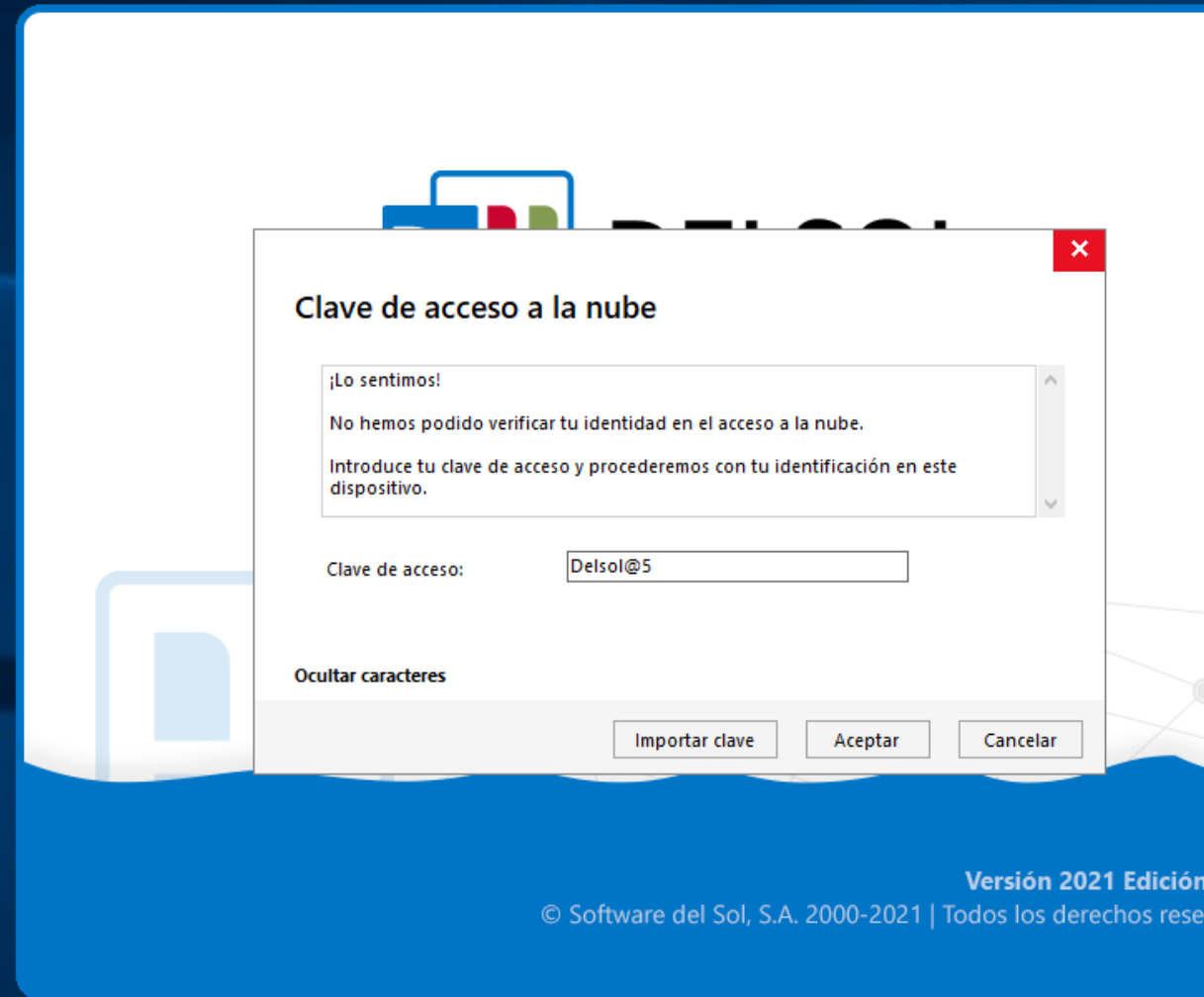

User List

At this point, "DELSOL" will have loaded the list of available users.

In order for you to view them, you will need to open the drop-down.

Specifically, there are 2:

- *Supervisor (administrator)*
- *General User (teachers / students)*

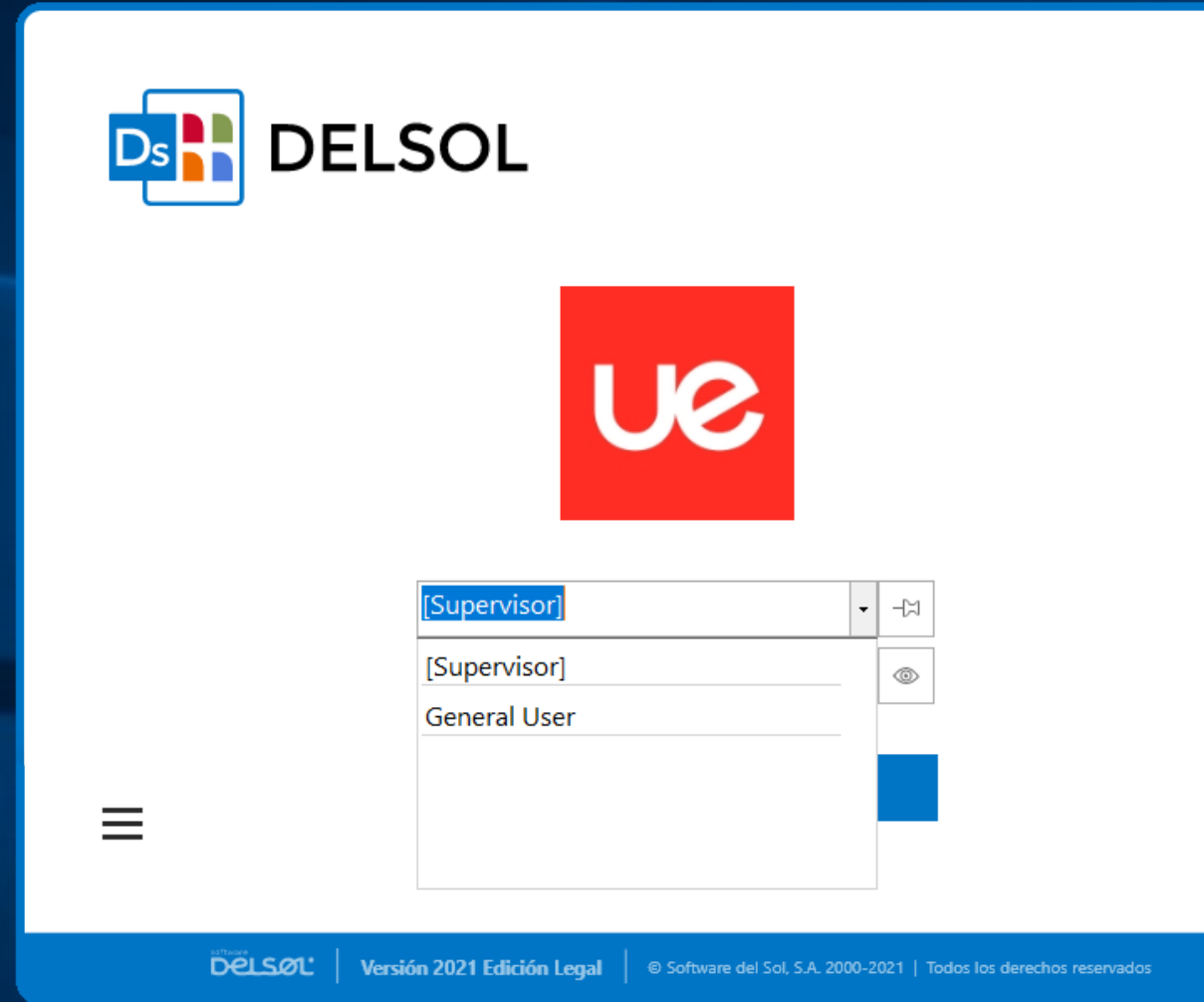

General User Selection

In order to use the application, you will have to select the user named “General User”, and log in.

This user does not require a password.

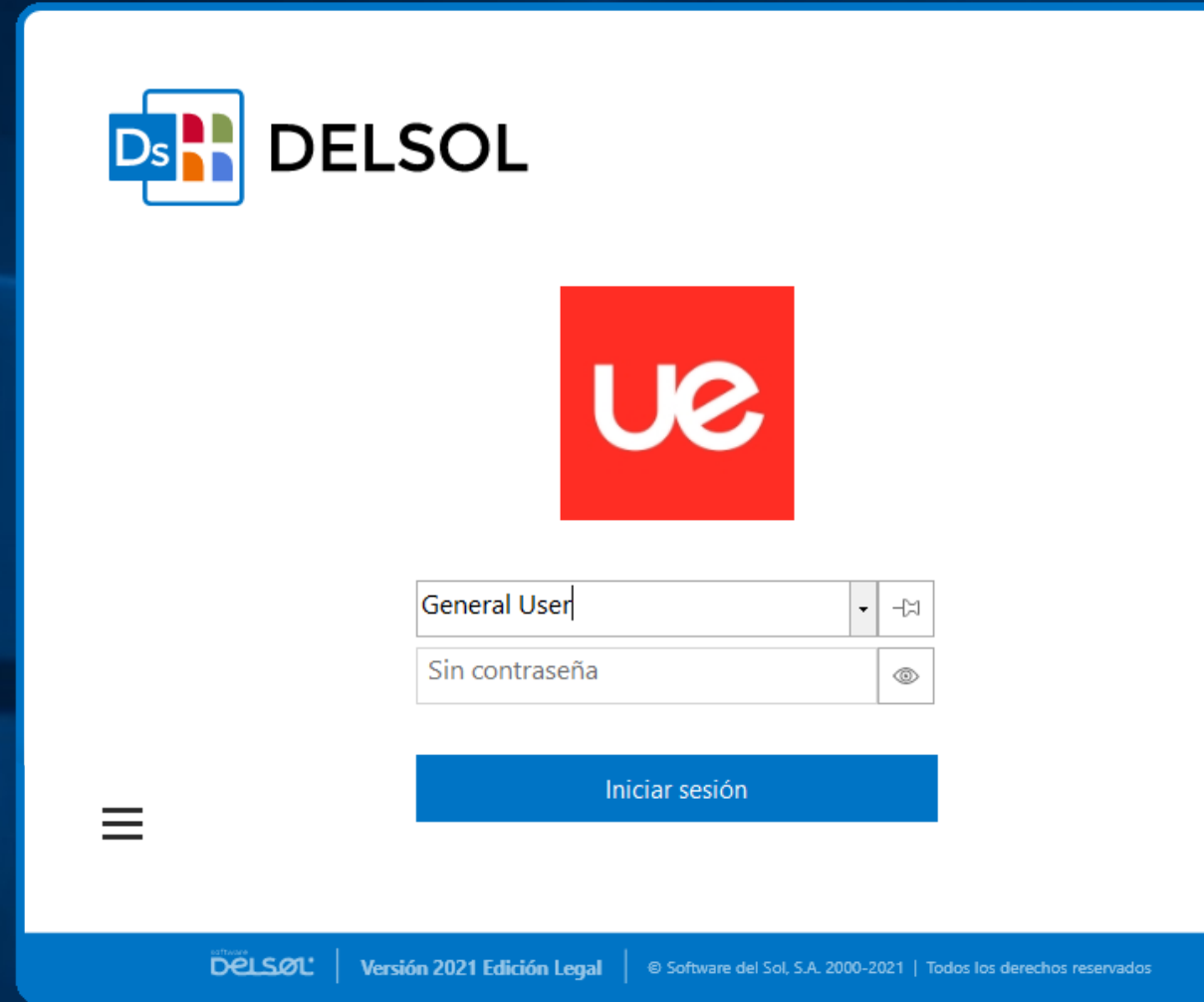

The screenshot displays the login page for the DELSOL application. At the top left, the DELSOL logo is visible, consisting of a blue square with 'Ds' and a colorful grid, followed by the text 'DELSOL'. Below the logo is a red square containing the white text 'ue'. The login form includes a dropdown menu with 'General User' selected, a password field with 'Sin contraseña' and an eye icon, and a blue 'Iniciar sesión' button. A hamburger menu icon is located in the bottom left corner. The footer contains the DELSOL logo, 'Versión 2021 Edición Legal', and copyright information: '© Software del Sol, S.A. 2000-2021 | Todos los derechos reservados'.

DELSOL started

Finally, when you get to this last step, you have successfully started "DELSOL".

Congratulations!

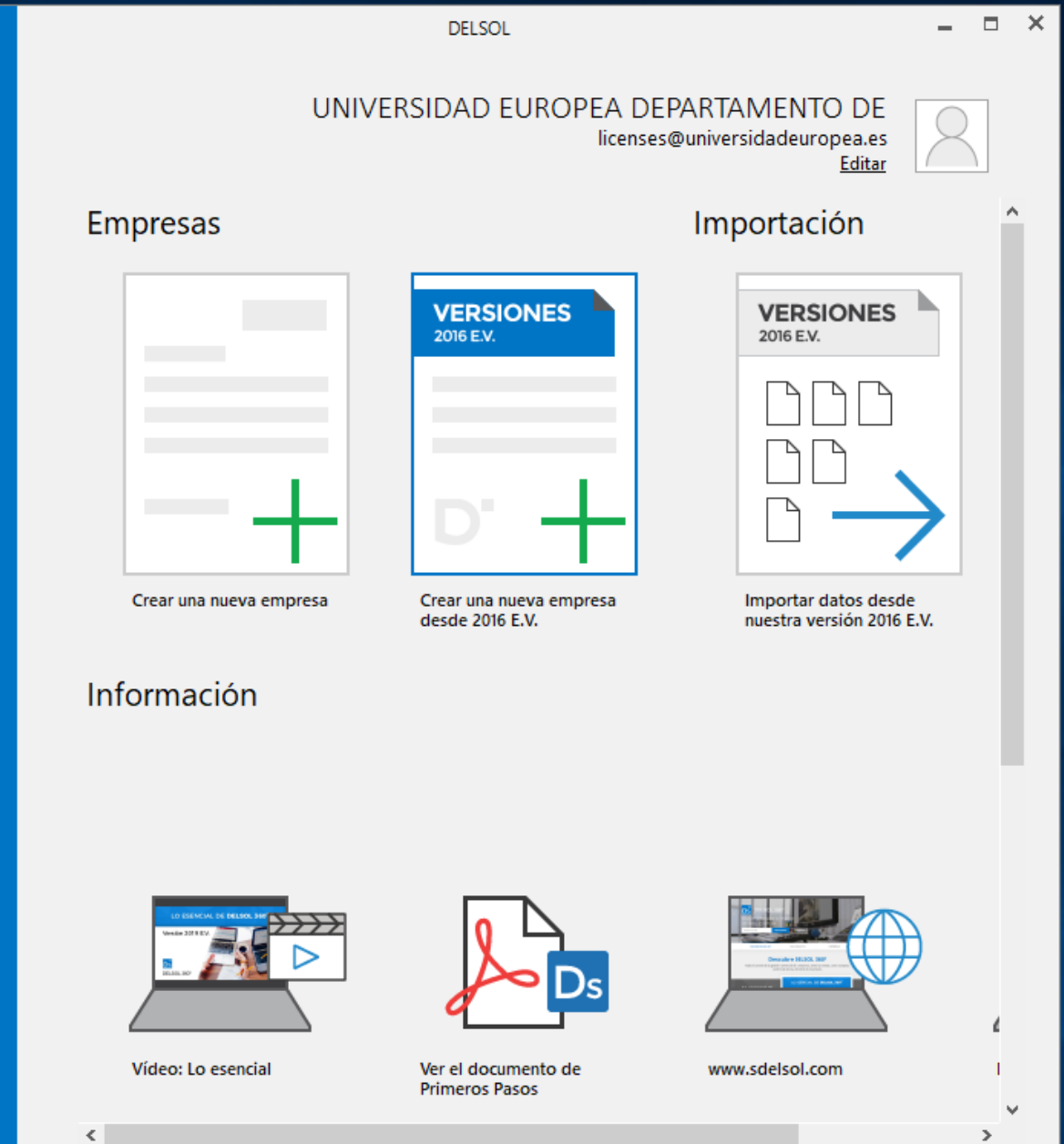

UNIVERSIDAD EUROPEA DE MADRID

(+34) 91 740 7272 C/ Tajo, s/n Villaviciosa de Odón 28670,
Madrid

Av. Fernando Alonso, 8 Alcobendas 28108, Madrid

UNIVERSIDAD EUROPEA DE VALENCIA

(+34) 96 104 3883 C/ General Elio, 2, 8 y 10 46010,
Valencia Edificio Europa Avda. Aragón, 30 46021, Valencia

UNIVERSIDAD EUROPEA DE CANARIAS

(+34) 92 298 5050 C/ Inocencio García, 1 La Orotava,
38300, Tenerife

